



INTERNATIONAL RAILWAY SYMPOSIUM 2023 - **SUSTAINABLE RAILWAY: CONNECTING NATIONS, PRESERVING FUTURES**

A Journey From The Past And To The Future

A presentation by:
Amiruddin Ma'aris
Project Director, Putrajaya Line
Mövenpick Hotel & Convention Centre KLIA
6 Nov 23



INTERNATIONAL RAILWAY SYMPOSIUM 2023 - **SUSTAINABLE RAILWAY: CONNECTING NATIONS, PRESERVING FUTURES**

A Journey From The Past And To The Future

1. Overview
2. The Past – Why MRT?
3. The Future – What MRT?
4. Sustainable Railway



INTERNATIONAL RAILWAY SYMPOSIUM 2023 -

SUSTAINABLE RAILWAY: CONNECTING NATIONS, PRESERVING FUTURES



..... remember the
EIRR.....



INTERNATIONAL RAILWAY SYMPOSIUM 2023 - **SUSTAINABLE RAILWAY: CONNECTING NATIONS, PRESERVING FUTURES**

A Journey From The Past And To The Future

1. Overview
2. The Past – Why MRT?
3. The Future – What MRT?
4. Sustainable Railway



1. Overview.....Organisation Structure

MRT Corp is the developer of urban rail transport infrastructure, catalysing sustainability of cities and mobility of people.

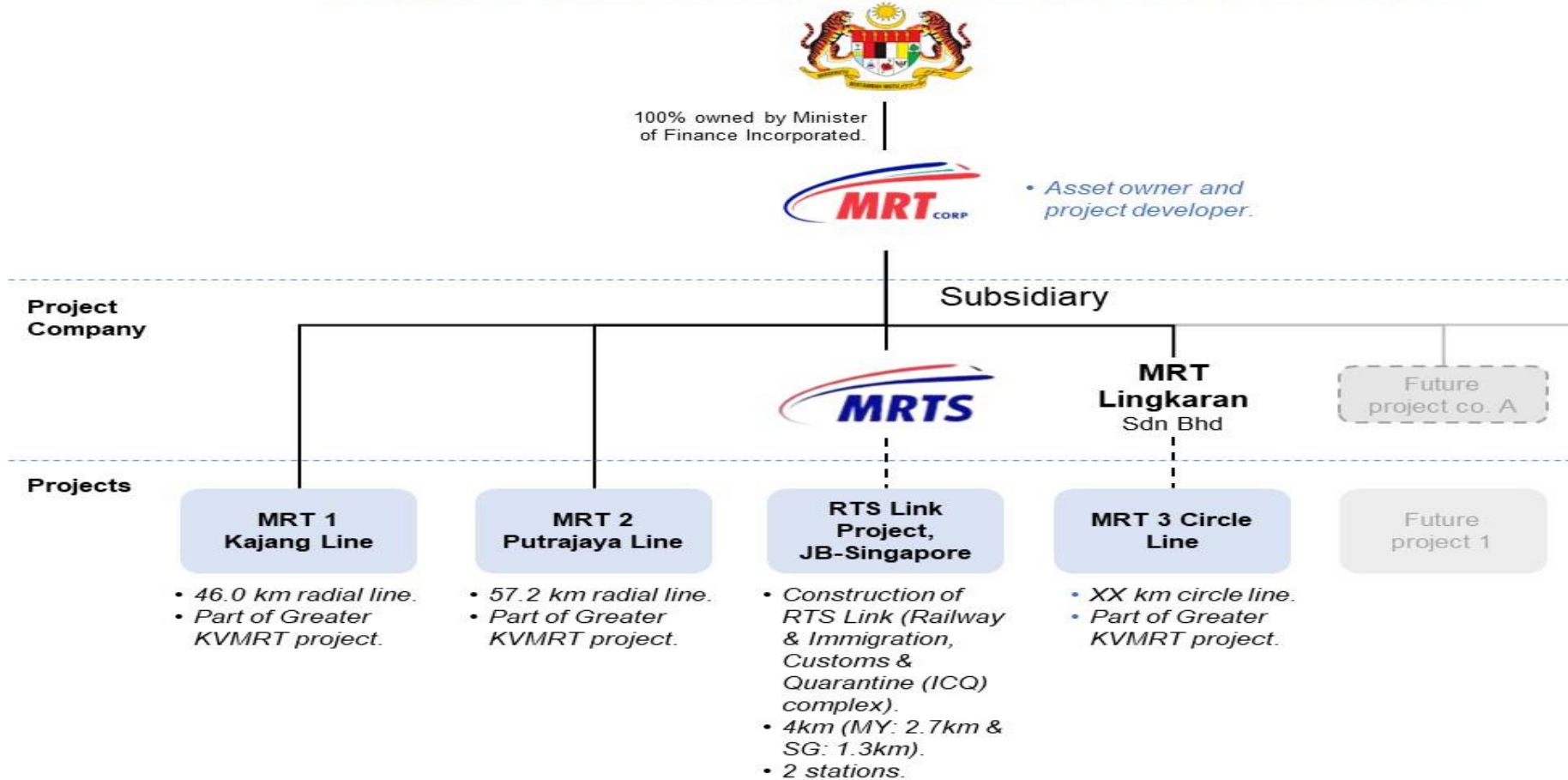

1. Overview..... PYL *Kiosks & Station Naming Rights, anybody.....*



1. Overview..... PYL Phase 2 Opening 16 Mar 23

MRT LALUAN PUTRAJAYA

Tahukah Anda?

- Jarak dalam Kilometer **57.7** km
- Jarak laluan bertingkat **44.2** km
- Jarak laluan bawah tanah **13.5** km
- Jumlah stesen beroperasi **36**
- Jumlah stesen pertukaran **10**
- Stesen bawah tanah **9**
- Stesen dengan tempat letak kereta **17**
- Anggaran masa perjalanan **84** minit

www.myrapid.com.my | @myrapid | @AskRapidKL | myrapidkl

MRT LALUAN PUTRAJAYA

Kwasa Damansara - Putrajaya Sentral

PETUNJUK

- Stesen Sambungan
- Stesen Pertukaran
- Stesen LRT
- Stesen MRT
- Stesen KTM
- Stesen MAMPU
- Stesen MAMPU
- Stesen MAMPU
- Stesen MAMPU
- Stesen MAMPU

Stations (from Kwasa Damansara to Putrajaya Sentral):

- Hospital Kuala Lumpur
- Tidwangsa
- Sentul Barat
- Jalan Ipoh
- Kentonmen
- Kampung Batu
- Sri Delima
- Jinjang
- Kepong Baru
- Metro Prima
- Sri Damansara Timur
- Sri Damansara Sentral
- Sri Damansara Barat
- Damansara Damai
- Sungai Buloh
- Kampung Selamat
- Raja Uda
- Ampang Park
- Persiaran KLCC
- Conlay
- Tun Razak Exchange (TRX)
- Chan Sow Lin
- Kuchai
- Taman Naga Emas
- Sungai Besi
- Serdang Raya Utara
- Serdang Raya Selatan
- Serdang Jaya
- UPM
- Taman Equine
- Putra Permai
- 16 Sierra
- Cyberjaya Utara
- Cyberjaya City Centre
- KWASA DAMANSARA
- PUTRAJAYA SENTRAL

MRT

LALUAN PUTRAJAYA



1. Overview..... PYL unique features



Kwasa Damansara



Damansara Damai



UG Titiwangsa



Jalan Ipoh



1. Overview..... PYL unique features



Ampang Park – VANS Skate Park



Ampang Park – VANS Skate Park



Kuchai – Event Space



Putrajaya Sentral



Kentonmen



1. Overview..... RTS..... international & on track

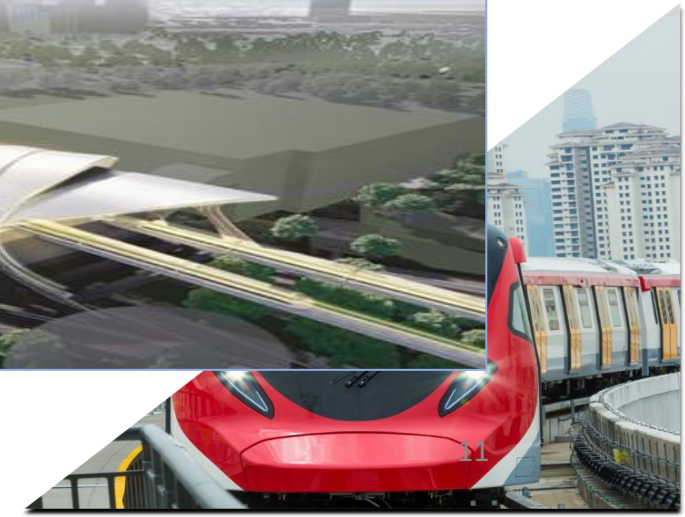
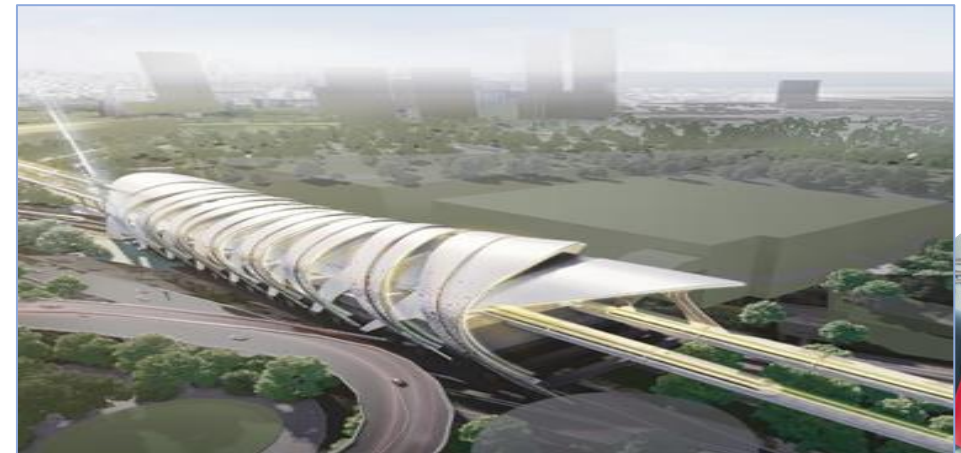
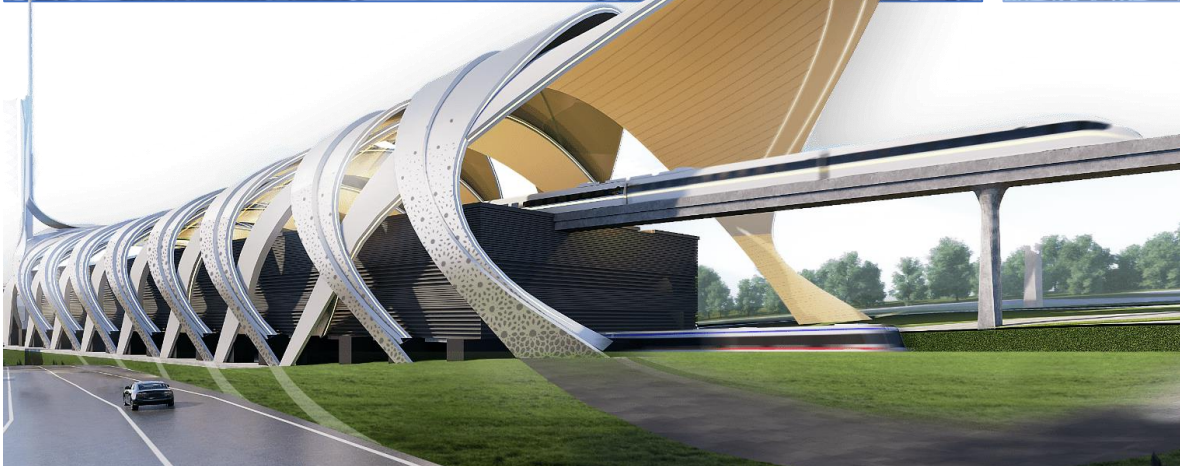
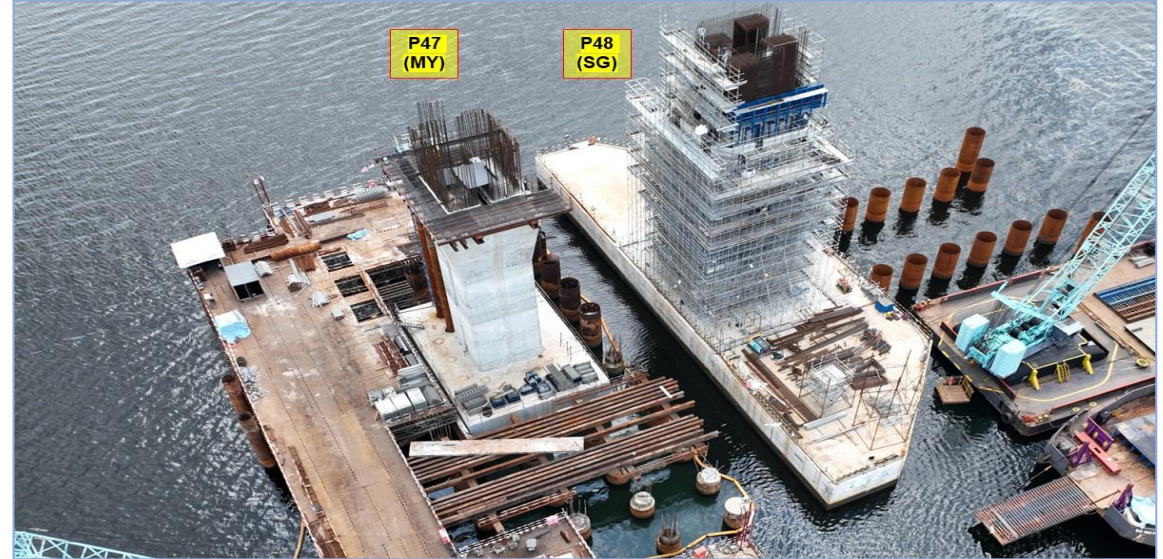

INTERNATIONAL RAILWAY SYMPOSIUM 2023 - **SUSTAINABLE RAILWAY: CONNECTING NATIONS, PRESERVING FUTURES**

A Journey From The Past And To The Future

1. Overview
- 2. The Past – Why MRT?**
3. The Future – What MRT?
4. Sustainable Railway



2. The Past – Why MRT? a National Objective



The initial six NKRAs are Reducing Crime, Fighting Corruption, Improving Student Outcomes, Raising Living Standards of Low Income Households, Improving Rural Basic Infrastructure and **Improving Urban Public Transport** that have been under the GTP since its introduction in 2010

To transform the economy we need to focus 12 National Key Economic Areas (NKEAs)



Greater KL 20-20 by 2020
To be among the world's Top 20 performing cities on economic growth and liveability rankings by 2020

GREATER KL

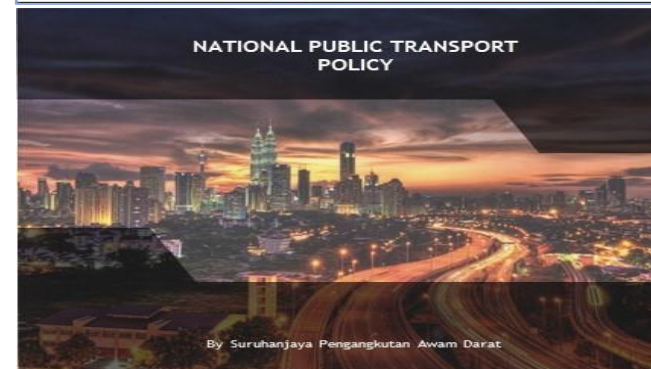

2. The Past – Why MRT?the Blueprint

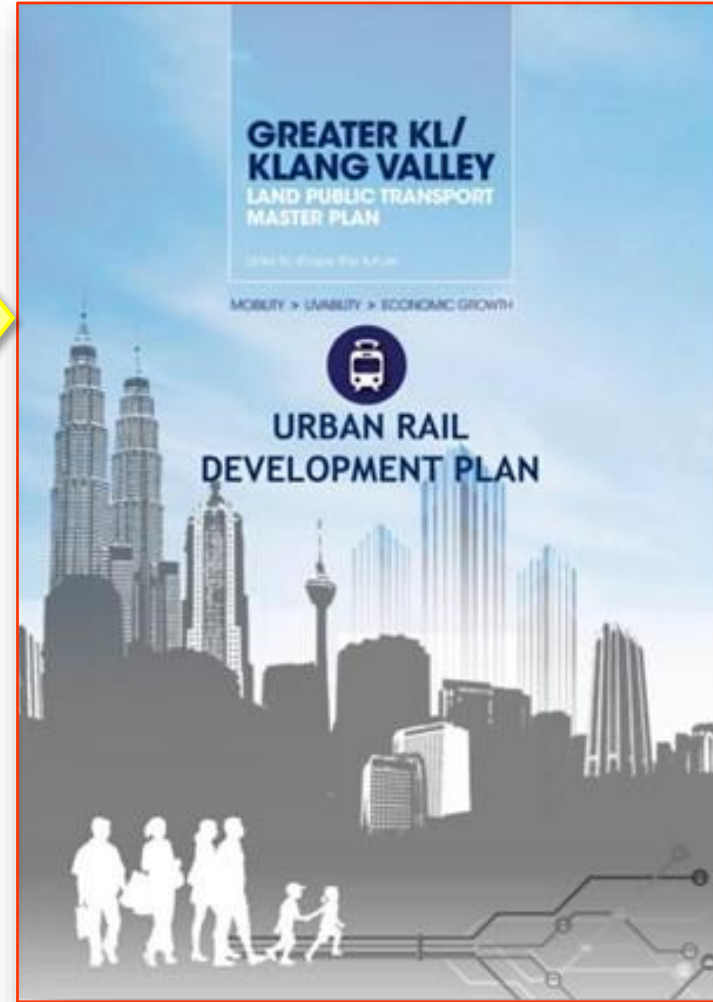
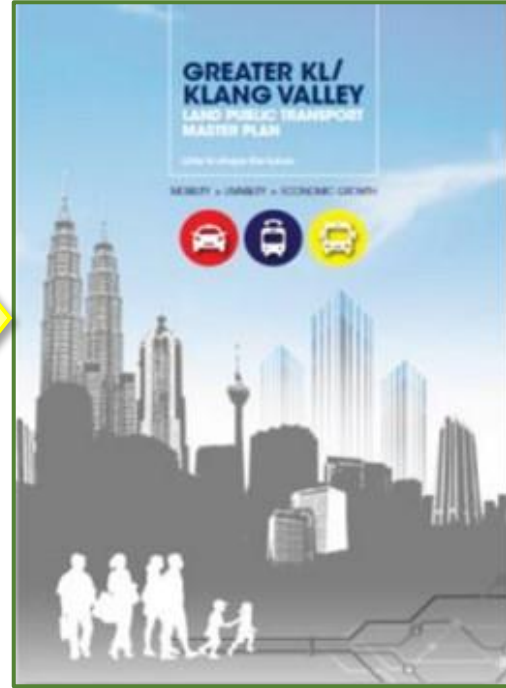
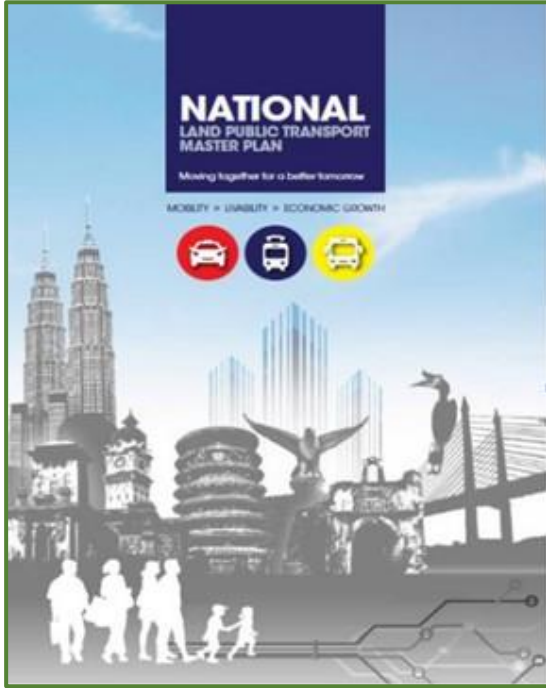

- ✓ **Mobility**
- ✓ **Livability**
- ✓ **Economic Growth**



2. The Past – Why MRT? a POWERFUL Reminder..... do the math

177 cars



3 buses



1 train-car



- 1 trainset – 1200 pax peak hour
- 1200 private vehicles @ 12M separation
- 14 KM or 7 KM two-lane road



INTERNATIONAL RAILWAY SYMPOSIUM 2023 - **SUSTAINABLE RAILWAY: CONNECTING NATIONS, PRESERVING FUTURES**

A Journey From The Past And To The Future

1. Overview
2. The Past – Why MRT?
- 3. The Future – What MRT?**
4. Sustainable Railway



3. The Future – What MRT? what else??

Synonyms & Similar Words

- | | | |
|-------------|--------------|------------|
| endurable | sufferable | tolerable |
| supportable | acceptable | bearable |
| survivable | livable | adequate |
| liveable | satisfactory | allowable |
| reasonable | permissible | admissible |

Sustainability consists of fulfilling the needs of current generations without compromising the needs of future generations, while ensuring a balance between economic growth, environmental care and social well-being

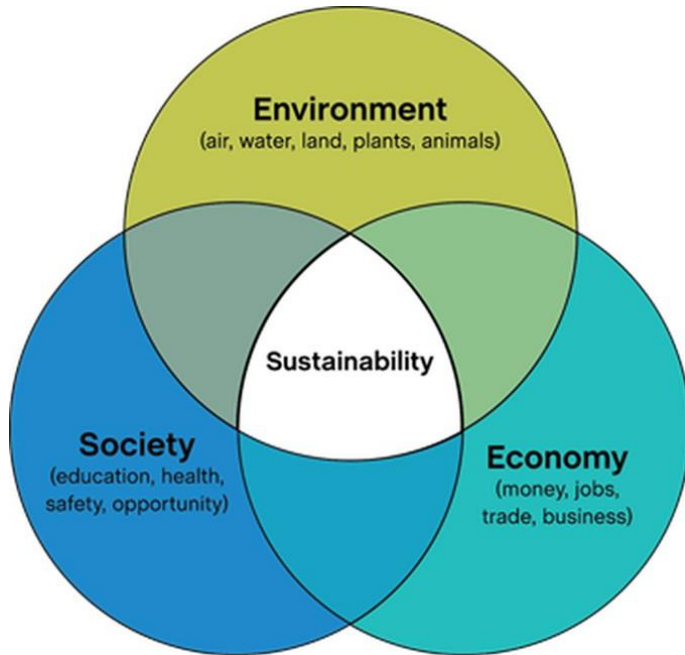

What is economic sustainability?
 Economic sustainability is the practice of conserving natural and **financial resources to create long-term financial stability**



INTERNATIONAL RAILWAY SYMPOSIUM 2023 - **SUSTAINABLE RAILWAY: CONNECTING NATIONS, PRESERVING FUTURES**

A Journey From The Past And To The Future

1. Overview
2. The Past – Why MRT?
3. The Future – What MRT?
4. **Sustainable Railway**



4. Sustainable Railway..... we need CHAMPIONS with PASSIONS



Land Use – Linear – Hotspots

- Mobility Corridor – Stronger/Revise Enactment/Special Act – Timeline Alignment with other Developers

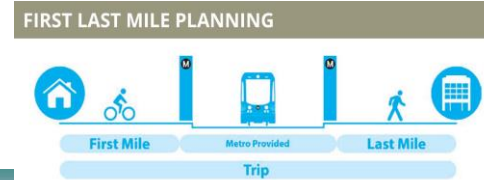

First & Last Mile

- Backbone (not served, underserved, enhanced connectivity), PBT-driven/community driven/empowerment. microtransit



Integrated Policy & Push – Pull

- Transit-First – Concessions/MoW – UKAS/PPPU – Automotive/MITI
- Push – unpopular but a necessity



Nurturing Talent & Scalable Capacity Development

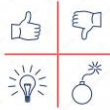

Master Plan (to sustain) & Stakeholders Composition

- Invest ≠ Sustain (downward spiral), city limit, Sustainable Fund



Yield Management, Carrot & Stick, Fare Revisions



4. Sustainable Railway..... Back to _



Know your customers – past, existing, new, would-be, fence-sitters, opportunists



Travel Pattern Vs Customers' Profiles/Needs/Behaviour



Selling to demand NOT demanding selling (Take it or Leave it)



'No Policy' Policy



Data Mining/Harvesting, Consolidation & Incentive Refinement



4. Sustainable Railway..... One stone many birds ouch!

Where or when a railway is not just a railway - catalyst for parallel pressing issues – housing – vertical space, community development – urban poor, mental health/recreational.....



..... do the math

4. Sustainable Railway..... economics + social + environment

Where or when a railway is not just a railway - catalyst for parallel pressing issues – housing – vertical space, community development – urban poor, mental health/recreational.....

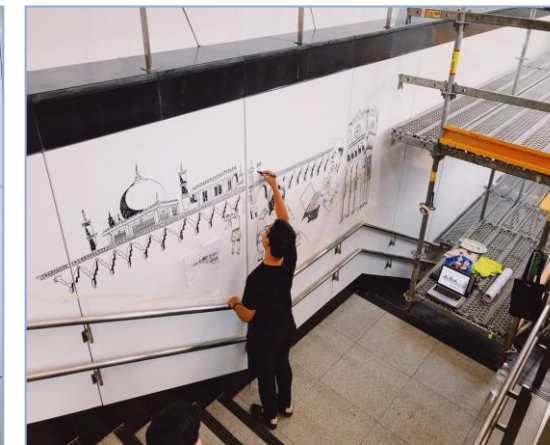
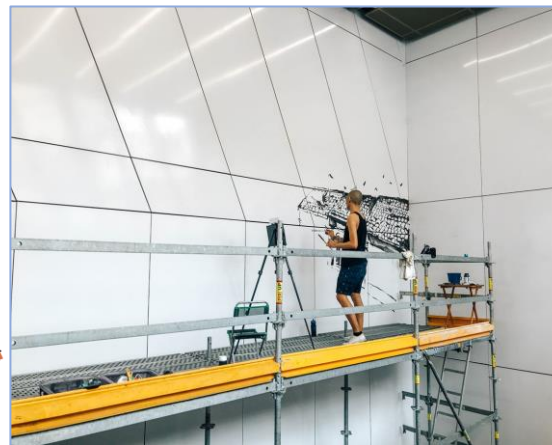
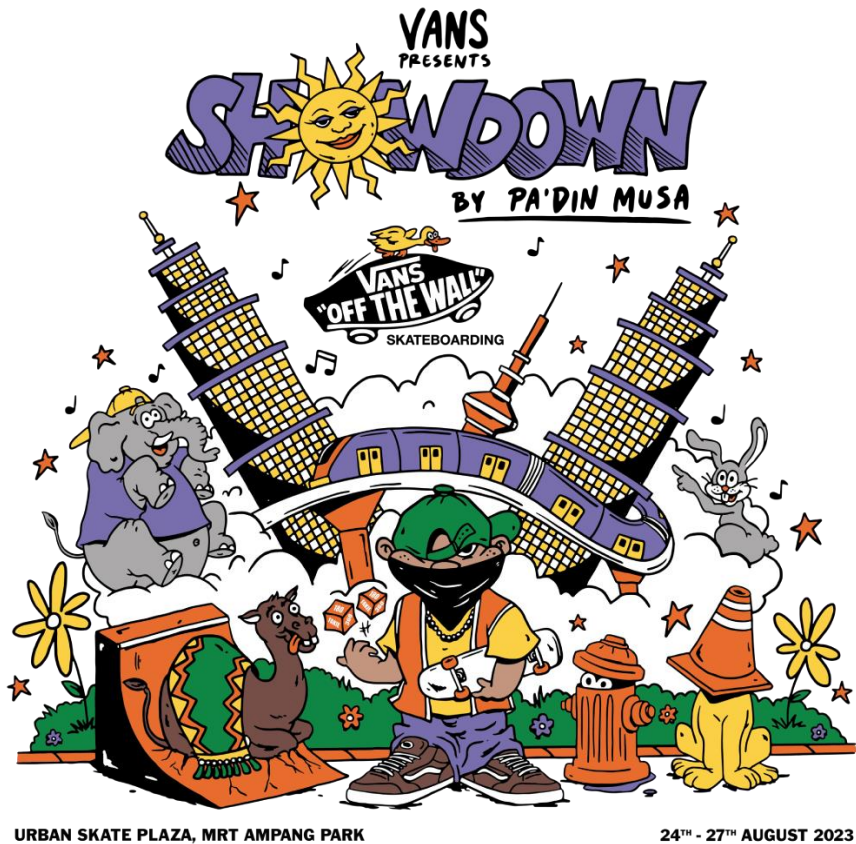

..... work and no play....., and no space.....



4. Sustainable Railway..... who reaps the EIRR.....? Return some please....



4. Sustainable Railway..... back to policies....facts and figures....



Ferry Building, San Francisco. Before Loma Prieta Earthquake and after.

... giving
back to the
society



INTERNATIONAL RAILWAY SYMPOSIUM 2023 - **SUSTAINABLE RAILWAY: CONNECTING NATIONS, PRESERVING FUTURES**

A Journey From The Past And To The Future

1. Overview
2. The Past – Why MRT?
3. The Future – What MRT?
4. Sustainable Railway



When you are stressed
you eat ice cream, cake,
chocolate and sweets.

Why?

Because 'stressed' spelt
backwards is 'desserts.'



Thank you

**“The right train of thought can take
you to a better station in life”**

Quote from quoteistan

